

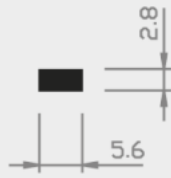

Nr. 9/25 W

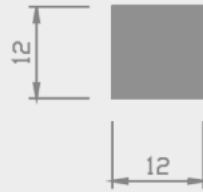

Nr. 40/24 H



Nr. 6/45 HH



Nr. 6/46 H

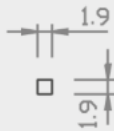

Nr. 6/3 HDPE

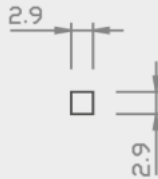

Nr. 6/4 HDPE

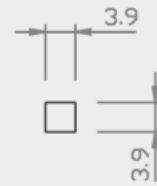

Nr. 6/5 HDPE

■ = Hart PVC

■ = Weich PVC | HH = Halbhart PVC

□ = Andere Kunststoffe